

**Max**<sup>TM</sup>  
2M  
ulricheasyINJECT

Contrast media injector for MRI and  
digital, contrast-enhanced mammography

**New:**  
Digital, contrast-enhanced  
mammography



24 h

24-hour multi-use  
in MRI



## Advantages at a glance



### Quick and easy

- Set up just once daily
- Rapid patient changeover
- Intuitive user interface



### Cost-effective and efficient

- Low cost for disposables
- Optimized contrast media management
- Efficient workflows



### Hygienic and safe

- Closed system: Direct injection from original media containers
- Automatic air monitoring on the patient side
- SafeConnect with protection against accidental touching

# Innovation made in Germany

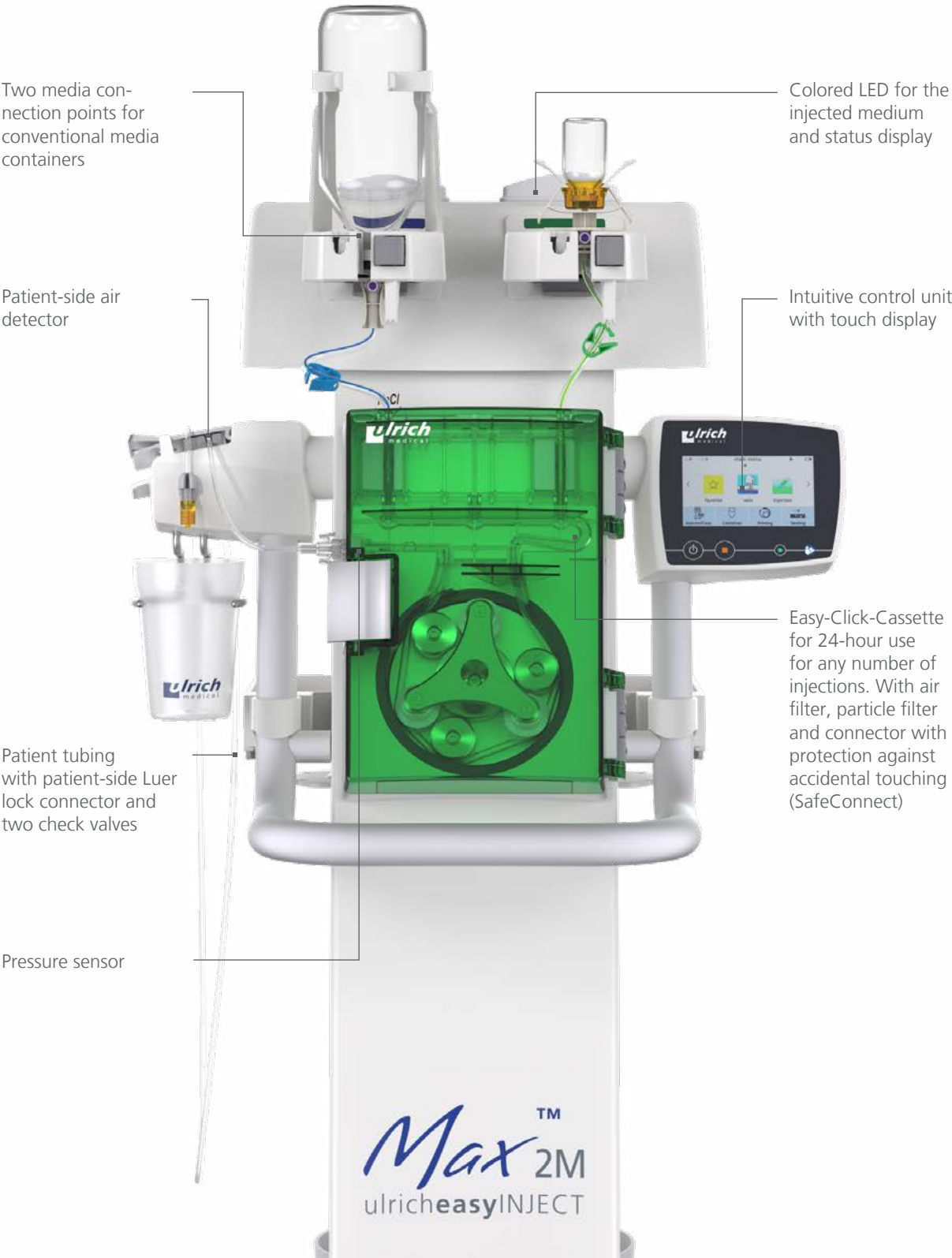

## Simple use

- Set up just once daily
- 24-hour use of the Easy-Click-Cassette
- Rapid patient changeover
- Intuitive user interface
- Cable-free operation
- Exact timing of the injection

### Setup made easy

- Insert Easy-Click-Cassette
- Connect patient tubing
- Attach media containers
- Done!

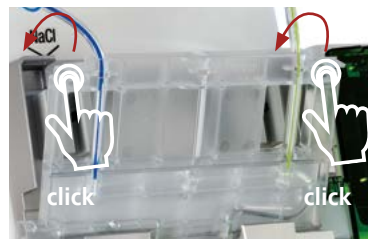

### Change of patient tubing in a few seconds

- Remove patient tubing
- Connect new patient tubing
- Done!

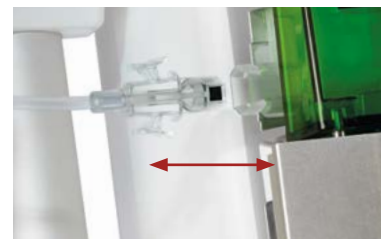

## Cost-effective and efficient

- Low cost for disposables
- Optimized contrast media management through the use of large containers
- Efficient workflows

## Focused on hygiene & safety

- SafeConnect with protection against accidental touching
- Easy-Click-Cassette verified for 24-hour use<sup>1</sup>
- Reliable protection against retrograde contamination<sup>2</sup>
- Direct injection from the original media containers
- Protection against air injection by means of air detector on the patient side
- Closed system

<sup>1</sup> Source: GLP-compliant study: „Microbiological Contamination Control Study of the ulriceasy-INJECT Max 3 System“, Report 12046467, dated 2018-02-28, Author: UL International GmbH (Grenzenstr. 13, 88416 Ochsenhausen, Germany); Study is not published, available on request by non-disclosure agreement.

<sup>2</sup> Source: GLP-compliant study: “Virological evaluation of Retrograde Contamination Potential at the Pump Tubing Set (XD 8003) and the Patient Tubing Set (XD 2035) of the CT motion (XD 8000)”, Report 10874251 2.1, dated November 12, 2015, Author: UL International GmbH (Grenzenstr. 13, 88416 Ochsenhausen, Germany); Study is not published, available on request by non-disclosure agreement. The results of the above mentioned non-clinical testing are transferable to the ulriceasyINJECT systems Max 3 and Max 2M, as the physical barrier against possible retrograde contamination in all systems is realized by identical check valves.

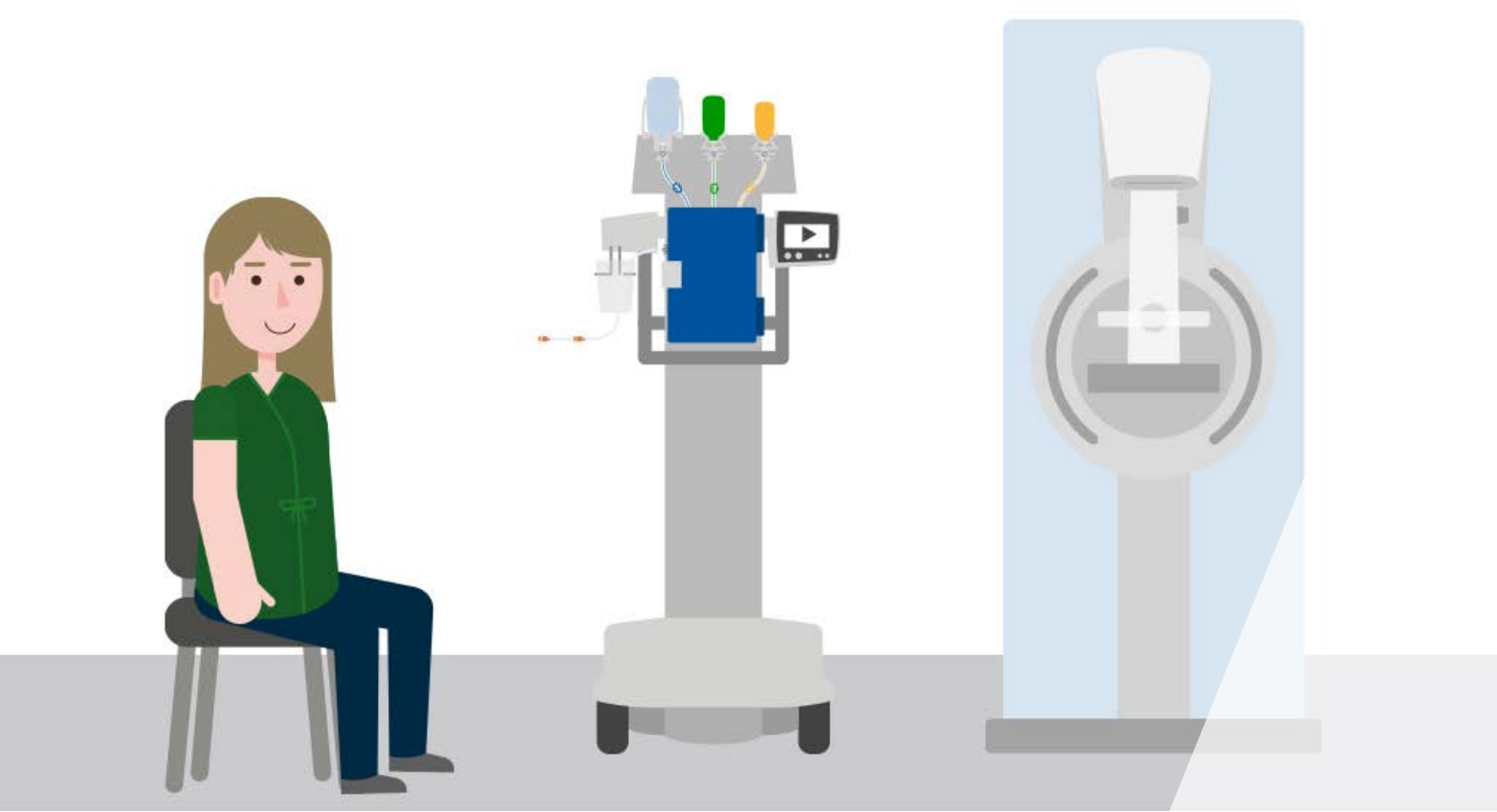

**New**

## Digital, contrast-enhanced mammography



- Enables fast operation and patient-side injection start directly on the injector
- Compact device base ensures sufficient space in the mammography room
- Using a contrast media injector provides a continuous flow of contrast media
- CM bolus is administered accurately, which then increases the quality of the imaging
- Cordless device concept for free and flexible positioning of the injector in the mammography room

# Overview of technical information

Dimensions (L x W x H) – without media rod	530 mm x 530 mm x 1,372 mm
Weight	Approx. 40 kg
Power supply	Rechargeable battery operation
Voltage supply (battery charging)	Voltage rating 100-240 VAC / 50/60 Hz
Media transport	Roll pump
Flow rate	0.1 to 10 mL/s, in increments of 0.1 mL/s (MRI) 0.1 to 4 mL/s, in increments of 0.1 mL/s (contrast-enhanced mammography)
Maximum injection volume	400 mL/patient 1 mL – 10 mL, in increments of 0,1 mL > 10 mL – 100 mL, in increments of 0,5 mL > 100 mL – 400 mL, in increments of 1 mL
Reservoir volume	Contrast media: max. 1 x 200 mL (MRI), max. 1 x 250 mL (contrast-enhanced mammography) NaCl: max. 1 x 1,000 mL, or max. 1 x 2,000 mL with pouch and optional media rod
Adjustable pressure limit	2 – 14 bar in increments of 0.1 bar (29 – 203 psi in increments of 1 psi)
Air monitoring	3 detectors for the media supply tubing, 1 detector for Easy-Click-Cassette and patient tubing
Pressure monitoring	1 pressure sensor
User interfaces	Terminal: 12" color TFT touch screen, injector: 4" color TFT touch screen
Data import and export	USB interface
Data transfer from injector to terminal	WLAN (802.11 b/g/n)
Number of boli (phases) per injection program	Max. 40
Number of injection programs that can be saved	Max. 200
Pressure curve	Real-time display of the injection pressure curve
Software functions (standard)	Remainder display NaCl Backup Manual pause / time-controlled pause Timer Elapsed time
Software options	Vein-check, same patient: multiple injections per patient
Injector accessories	Convenience package: media rod, waste bin and tray
Disposables	Patient tubing 2.5 m or 3.2 m, Easy-Click-Cassette with holder s or holder l Adapter rings for small bottles

Sustaining member of the German Society for Hospital Hygiene (Deutsche Gesellschaft für Krankenhaushygiene e.V.)

**Over a Century  
of Innovation**

patented  
or/and  
pat. pend.



ulrich GmbH & Co. KG | Buchbrunnenweg 12 | 89081 Ulm | Germany  
Phone: +49 731 9654-0 | Fax: +49 731 9654-199  
injectors@ulrichmedical.com | www.ulrichmedical.com